

Item number: BC.HTA.00.408.20000

Revision: 00 · Date: 01 - 2025

Legend Gear accessory bag LA9

 ~ 0.25 h.

EASY      DIFFICULT

ENGLISH Thank you for choosing this premium product from SW-MOTECH. Visit our online shop for more information (e.g. model assignments). Required documents (e.g. national type approval) are available there for you to download.

Please read and understand all the instructions, safety information and warnings in these mounting instructions before mounting and using the product in order to avoid injury and damage. Keep these mounting instructions for reference.

This product was developed for vehicles in factory condition. Compatibility with original accessories or accessories from other manufacturers cannot be guaranteed.

These mounting instructions have been prepared to the best of our current knowledge. No legal claims relating to accuracy can be made. Errors and omissions excepted. We reserve the right to make technical and design changes. The copyright is held by SW-MOTECH.

SAFETY WARNING SYMBOL

 This warning symbol is used in these mounting instructions to warn of deadly dangers, injuries or other hazards. The words DANGER, WARNING or CAUTION are used as part of this warning symbol to convey important safety messages and information relating to the installation and use of this product. These words, together with the safety warning symbol, mean:

 **DANGER:** Indicates a hazardous situation which, if not avoided, will result in death or serious injury!

 **WARNING:** Indicates a hazardous situation which, if not avoided, may result in death or serious injury!

 **CAUTION:** Indicates a hazardous situation which, if not avoided, may result in minor or moderate injury!

 **NOTE:** Important information, but not relating to a risk of death or injury (property damage only)!

GENERAL INFORMATION

 **WARNING:** Assembly and/or maintenance of this product requires advanced technical skill, appropriate tools, and a good understanding of tool usage and torque specifications. For your own safety, SW-MOTECH recommends having the assembly and/or maintenance carried out by a qualified and certified motorcycle workshop.

 **WARNING:** If you do choose to assemble this product yourself, carefully and fully read the mounting instructions before assembly and use, and follow all instructions to avoid serious injury or death. Also observe all relevant information in the vehicle manual when mounting or using the product. IF YOU DO NOT UNDERSTAND ANY PART OF THESE MOUNTING INSTRUCTIONS OR NEED AN EXPLANATION AS TO A SPECIFIC INSTRUCTION, DO NOT ATTEMPT TO INSTALL THIS PRODUCT WITHOUT CONSULTING SW-MOTECH FOR ASSISTANCE!

PREPARATION: Read the mounting instructions carefully and make sure that all parts on the parts list are available.

 **CAUTION:** Ensure that your vehicle is standing securely. Switch off the engine and remove the ignition key. Allow the engine/exhaust to cool down if necessary. Disconnect the battery when working on the electrical system. Only use proper tools and always wear safety goggles and gloves during assembly and maintenance. Have a second person help you with assembly and maintenance.

ASSEMBLY: All parts and connections removed from the vehicle must be reinstalled according to the vehicle manufacturer's specifications or replaced with parts and hardware supplied by SW-MOTECH.

 **WARNING:** Secure all threads with a medium-strength liquid threadlocker, unless otherwise specified.

 **DANGER:** Tightening torques not defined by SW-MOTECH must be obtained from the vehicle manufacturer or a certified motorbike workshop.

FUNCTIONAL CHECK: After mounting the product, ensure that no moving parts are obstructed and that the function of the vehicle is not impeded. Cables and hoses must not rub against each other and/or be hindered in any way.

 **WARNING:** Carry out a comprehensive functionality check before you start to drive. Check the tightening torque of all connections and the tight fit of the product after the first 50 km and then at regular intervals. Mounted accessories can change the handling and stability of the vehicle.



SW-MOTECH GmbH & Co. KG
Ernteweg 7-10
35282 Rauschenberg
Germany



info@sw-motech.com
www.sw-motech.com



Take note of the symbols and what they mean in the ASSEMBLY section. If the term OEM appears in the ASSEMBLY section, the vehicle manufacturer's specifications must be observed and applied.



If you have any questions, please don't hesitate to contact our Customer Service team or our distributors. You can find our telephone number and a list of our distributors in our online shop:

www.sw-motech.com

PARTS LIST • READ AND KEEP MOUNTING INSTRUCTIONS!

1

1



BC.HTA.00.408.20000

 1/1

2



BC.ZUB.00.151.30000

 1/1

2

3



BC.ZUB.00.152.30000

 1/1

4



BC.ZUB.00.153.30000

 1/1

3

5



BC.ZUB.00.150.30000

 1/1

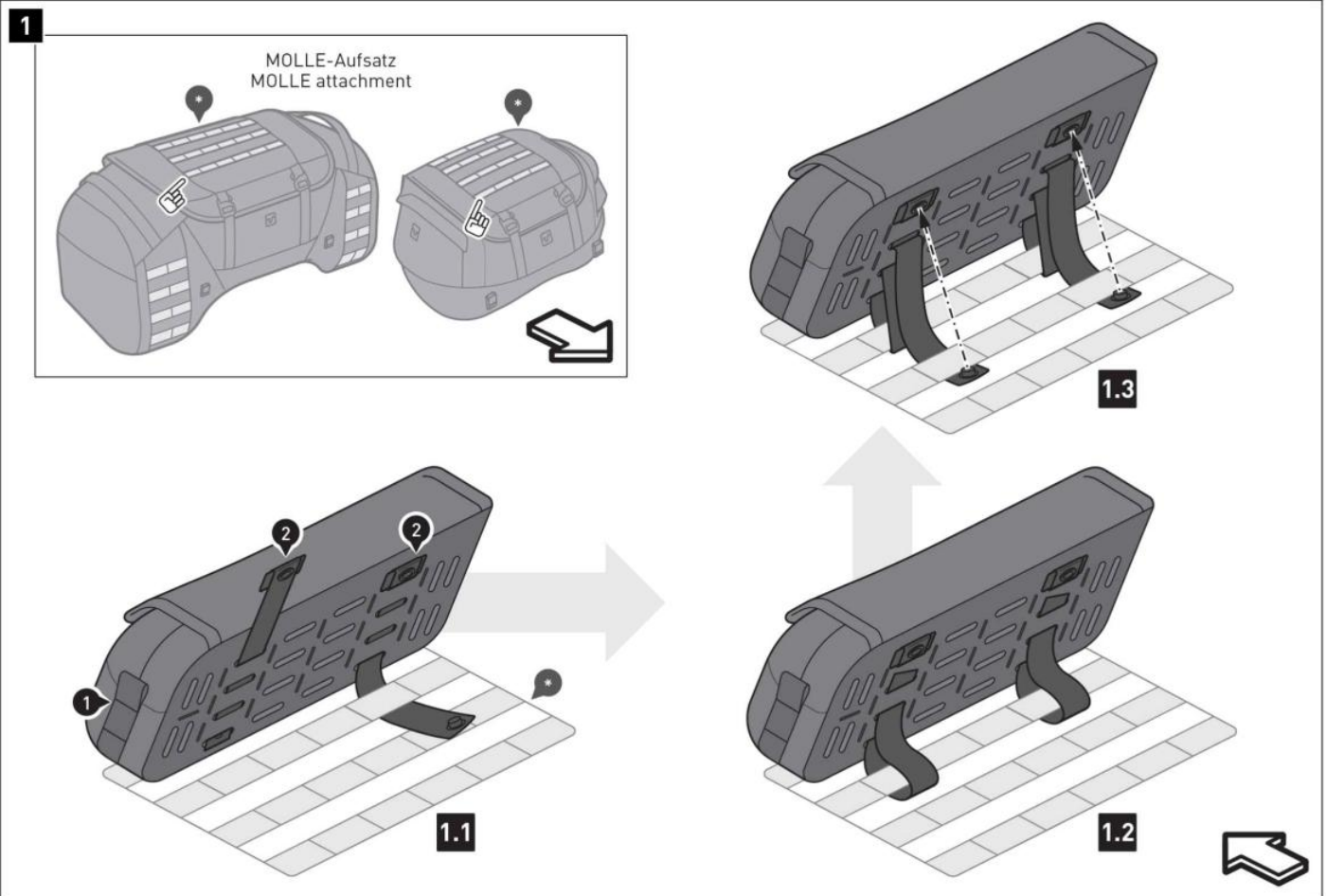

▲ **WARNING:** Always wear eye and hand protection!
 ▲ **WARNING:** Always use the proper tools!

▲ **NOTE:** The additional bag (1) can be attached to all SW-MOTECH products (*) with MOLLE connection options. The rear bags BC.HTA.00.405.2000* and BC.HTA.00.406.2000* are shown as examples.

▲ **NOTE:** The additional bag (1) should be attached only when empty.

▲ **NOTE:** Pay attention to the orientation of the accessory bag (1).

Step [1.1]

Guide both straps (2) completely through the outermost loops of the MOLLE rear panel of the accessory bag (1), and pull them as far as they will go. Then pass both straps (2) through the loops of the MOLLE system (*) to which the accessory bag is to be attached.

Step [1.2]

Pass both straps (2) through the loops of the MOLLE rear panel of the accessory bag (1). Tighten the straps (2).

Step [1.3]

Once again pass both straps (2) through the loops of the MOLLE system (*) to which the accessory bag is to be attached. Close the push button fasteners.

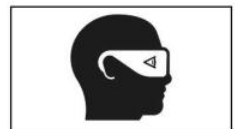

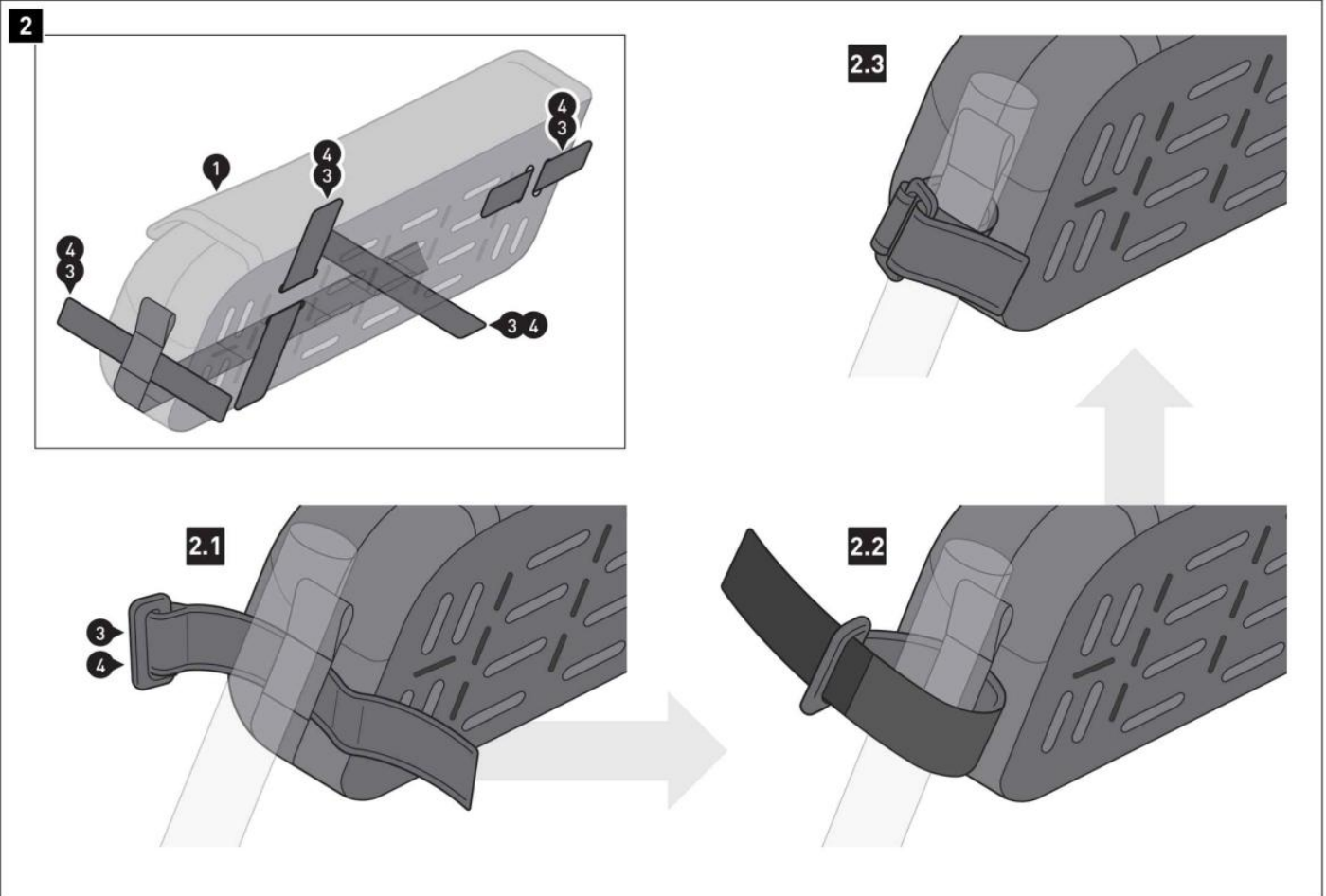

NOTE: The accessory bag (1) can be attached to the vehicle in various positions. The straps (3) and (4) can also be individually attached to the accessory bag (1) in various positions.

WARNING: The accessory bag (1) must always be attached to at least two attachment points.

Select suitable attachment points on the vehicle, with corresponding belt positions on the accessory bag (1), as well as the appropriate belt lengths (3) or (4).

Step [2.1]

Pass the straps (3) or (4) through the loops of the MOLLE system of the accessory bag (1).
Make sure the Velcro fastener is aligned correctly.

Step [2.2]

Wrap the straps (3) or (4) around the fastening bar and through the buckle.

Step [2.3]

Close the straps (3 or 4) with the Velcro fastener.

WARNING: Make sure that no components of the accessory bag (1) come into contact with hot and moving parts of the vehicle.
Also ensure that all components are at least 5 cm away from hot parts as well as hot gas coming from the exhaust!
After assembly, make sure that this distance is maintained in all vehicle positions!

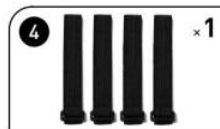

3



LOADING

⚠ NOTE: Always use the enclosed rain cover [5] to protect your luggage from moisture.

⚠ NOTE: Never store sharp or pointed objects that could injure persons or damage the vehicle or the accessory bag.

⚠ WARNING: The maximum load is 2 kg.



4



CARE

To clean, use **ONLY** a soft textile brush, cloth or sponge and some warm soapy water! Then rinse with clean water.
Do **NOT** use any harsh cleaning agents, abrasive cleaning utensils or pressure washers! Be sure to thoroughly clean the accessory bag after winter trips in order to prevent damage caused by salt.

⚠ NOTE: Surface materials may be subject to fluctuations in color (fading) if exposed to prolonged and intense sunlight or the elements (e.g. smog, acid rain, etc.)! SW-MOTECH accepts no liability for this type of wear!

PRODUCT-SPECIFIC NOTES

⚠ NOTE: Observe the country-specific regulations for the registration/operation of your vehicle or applicable TÜV regulations. Have parts that require registration entered in the vehicle documents by your test center after installation.

⚠ DANGER: Since this is a universal product, please make sure that the product can be attached and used properly and seamlessly on your vehicle type BEFORE using it for the first time! After attaching, check that all vehicle parts can move freely and function properly! Lamps such as taillights and turn light indicators must not be impeded in their function! Cables, wires and hoses should not rub and/or squeeze against anything!

⚠ DANGER: Carry out a comprehensive functional check before starting your journey!

⚠ DANGER: Check that the product sits firmly in place before starting your journey and at every rest stop (every 200 km)!

⚠ DANGER: The driving/braking behavior of the motorcycle changes noticeably after the attachment of this product!

⚠ DANGER: Lean angle and ground clearance may be restricted by this product!

⚠ DANGER: Not suitable for offroad use!

⚠ DANGER: The maximum vehicle load defined by the vehicle manufacturer may NOT be exceeded.

 see LOAD	 ≤ 130km/h (≤ 80mph)
--------------------------------------------------------------------------------------------	-------------------------------------------------------------------------------------------------------